



£130,000

🔑 TENURE: Freehold

📊 EPC RATING: E

💷 COUNCIL TAX BAND: A

Market Drayton

Frogmore Road
Market Drayton Shropshire

You'll be hopping mad if you miss your chance to make this cottage style terrace your new home so don't make a 'frog song and dance over it' and book your viewing.

The home would now benefit from cosmetic updating so if you are a keen DIY person, looking to add your own taste then this is for you. Located within walking distance of the town, close to many of the local facilities you'll have everything you need nearby. The end of terrace cottage has a small forecourt front garden and rear garden including two garden stores. Inside there are two reception rooms, kitchen and to the first floor two double bedrooms and bathroom.



- End Terraced Forecourted Cottage
- Two Reception Rooms & Two Bedrooms
- First Floor Bathroom
- Short Walk To The Town Facilities
- Rear Garden
- In Need Of Some Updating

You can reach us **9am to 9pm**, 7 days a week

14 Salter Street, Stafford, Staffordshire, ST16 2JU

01785 223344

hello@dourishandday.co.uk



Living Room 12' 2" x 12' 6" (3.70m x 3.81m)

A front entrance door leads into the living room which has a tiled fireplace and hearth, double glazed window to the front and door to the inner hallway.

Inner Hallway

Having under stair cupboard and open plan to the dining room and kitchen.

Dining Room 12' 0" x 8' 11" (3.65m x 2.72m)

Fire surround and gas fire and double glazed window to the rear.

Kitchen 9' 1" x 7' 9" (2.76m x 2.37m)

Base and wall units with work surfaces to three sides, inset stainless steel sink unit and drainer. Spaces for a cooker and washing machine. Double glazed door to the side and double glazed window to the rear.

Landing

Providing access to the two bedrooms.



Bedroom One 12' 0" x 11' 8" (3.66m x 3.55m)

A generous sized double bedroom with fitted wardrobes, radiator and double glazed window to the front.

Bedroom Two 11' 11" x 12' 6" (3.64m x 3.80m)

Having an airing cupboard housing the gas central heating boiler and over stair cupboard. Radiator and double glazed window to the rear. Door to the bathroom.

Bathroom 8' 11" x 7' 8" (2.72m x 2.34m)

Fitted with a panel bath, pedestal wash basin and low level WC. Tiling to the walls, radiator and double glazed windows to the side and rear.

Outside - Front

The home is set behind a walled forecourt garden.

Outside - Rear

There is a rear garden including yard adjacent to the property, two brick stores, greenhouse and further sun terrace.



GROUND FLOOR

1ST FLOOR

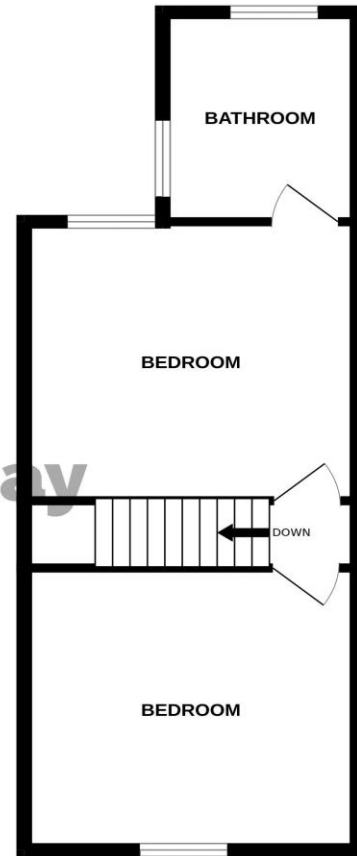
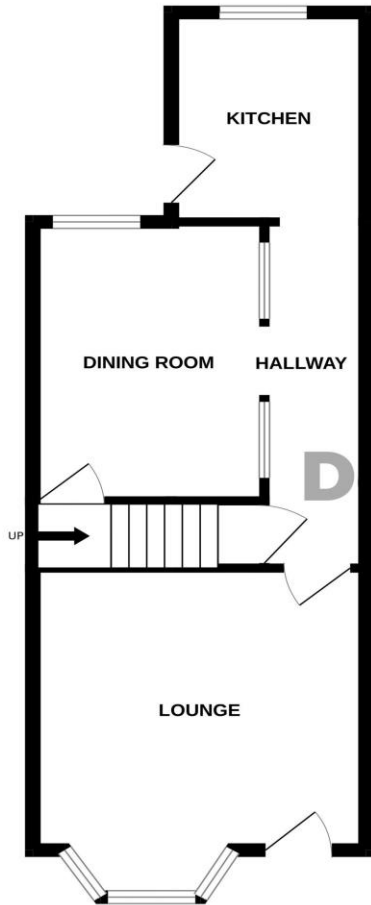

Dourish&Day

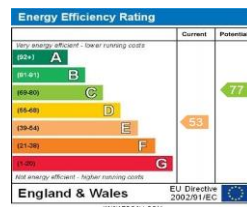

Whilst every attempt has been made to ensure the accuracy of the floorplan contained here, measurements of doors, windows, rooms and any other items are approximate and no responsibility is taken for any error, omission or mis-statement. This plan is for illustrative purposes only and should be used as such by any prospective purchaser. The services, systems and appliances shown have not been tested and no guarantee as to their operability or efficiency can be given.
Made with Metropix ©2024



IMPORTANT NOTICE Dourish & Day for themselves and for the vendor or lessors of this property whose agents they are given notice that: (i) the particulars are set out as a general outline only for the guidance of intending purchasers or lessees, and do not constitute, nor constitute part of, an offer of contract, (ii) all descriptions, dimensions, references to condition and necessary permissions for use and occupation, and other details are given in good faith and are believed to be correct but any intending purchasers or tenants should not rely on them as statement or representation of fact but must satisfy themselves by inspection or otherwise as to the correctness of each of them, (iii) no person in the employment of Dourish & Day has any authority to make or give any representation or warranty whatever in relation to this property.

You can reach us **9am to 9pm, 7 days a week**

14 Salter Street, Stafford, Staffordshire, ST16 2JU

01785 223344

hello@dourishandday.co.uk